



ADA Compliant

This Space for Architect/Engineer Approval

Job Name _____ Date _____

Model Specified _____ Quantity _____

Customer/Wholesaler _____

Contractor _____

Architect/Engineer _____

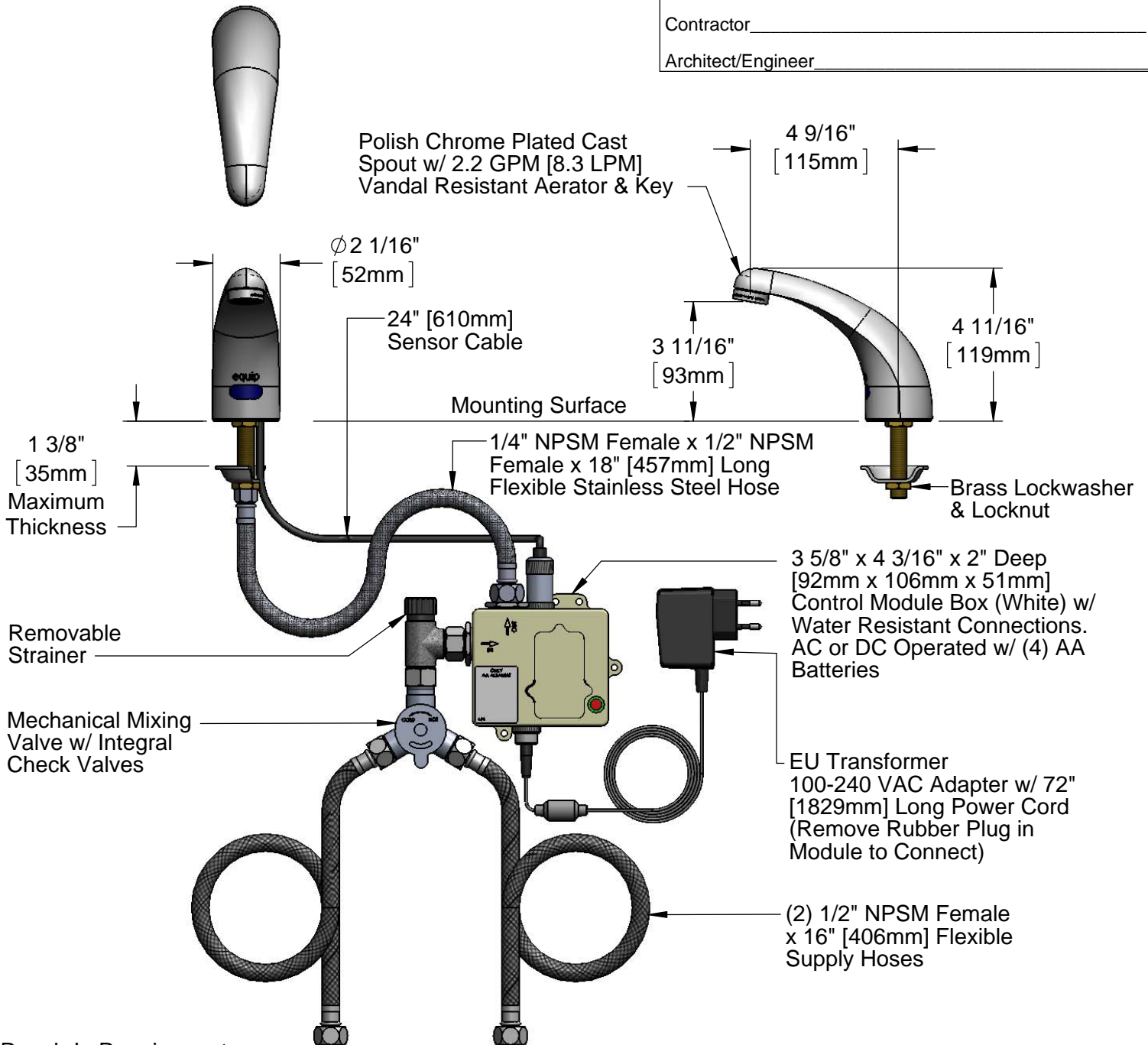

Rough-In Requirement:
Ø 1 1/4" [32mm] Mounting Hole

Model Number

5EF-EU1DS-C

Product Specifications:

Electronic Faucet: EU (European Style) Deck Mount Cast Spout Faucet, Control Module, AC-DC Control Module, EU Transformer, Mechanical Mixing Valve, Integral Check Valves & (2) 16" Flexible Supply Hoses

Product Compliance:

ASME A112.18.1 / CSA B125.1
NSF 61 - Section 9
NSF 372 (Low Lead Content)
ANSI A117.1 (ADA)
UL 1951

equip
Foodservice
Accessories

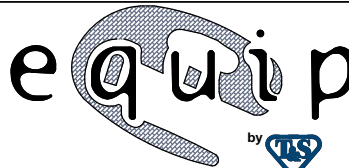

2 Saddleback Cove, P.O. Box 1088
Travelers Rest, South Carolina 29690
Phone: 800.891.4808 Fax: 800.868.0084
equip.tsbrass.com

ITEM NO.	SALES NO.	DESCRIPTION
1	015425-45	Vandal Resistant Key
2	B-0199-09	Vandal Resistant 2.2 GPM Aerator
3	5EF-0004	24" Sensor Cable
4	016297-45	Inlet Hose, Faucet, 1/2" NPSM-F x 1/4" NPSM-F
5	5EF-0001	equip Sensor Faucet - Control Module
6	5EF-0011	EU Transformer
7	016167-45	Supply Hose, 1/2 NPSM Female x 1/2 NPSM Female
8	5EF-0006	Mechanical Mixing Valve
9	5EF-FILTER	Replacement Filter

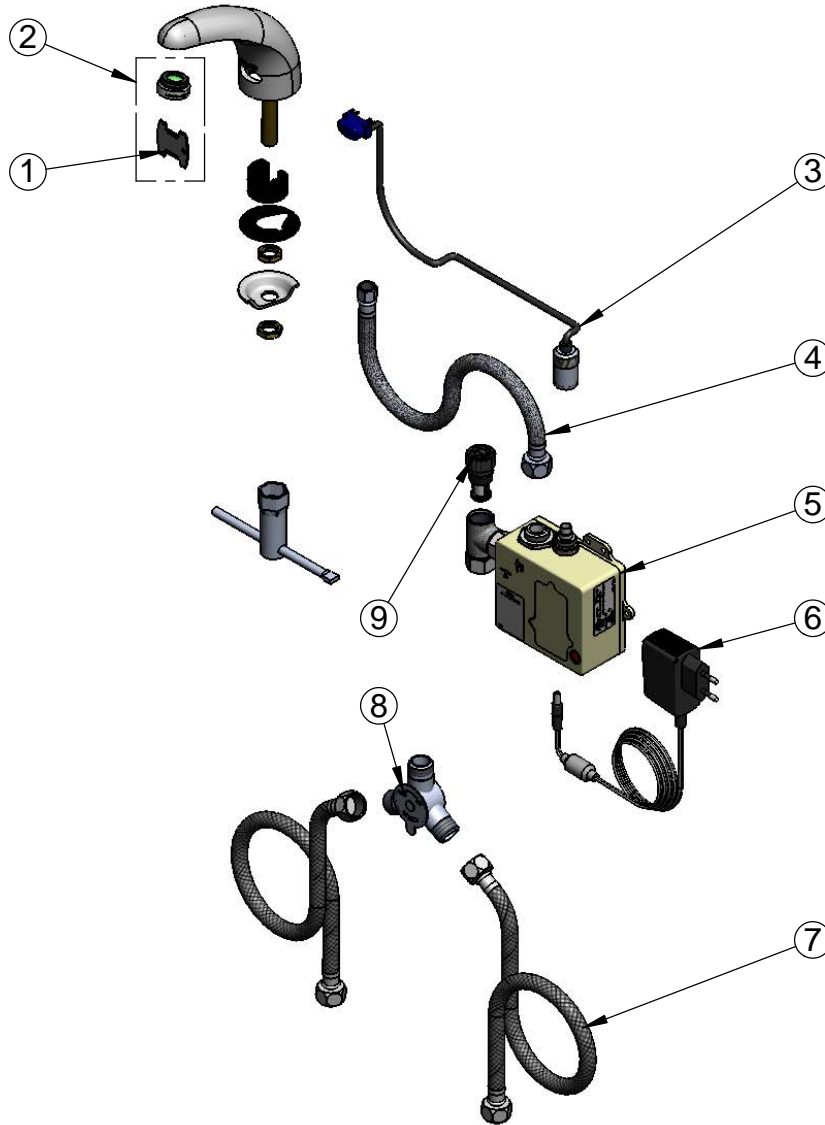

Model Number

5EF-EU1DS-C

Product Specifications:

Electronic Faucet: EU (European Style) Deck Mount Cast Spout Faucet, Control Module, AC-DC Control Module, EU Transformer, Mechanical Mixing Valve, Integral Check Valves & (2) 16" Flexible Supply Hoses

Product Compliance:

ASME A112.18.1 / CSA B125.1
 NSF 61 - Section 9
 NSF 372 (Low Lead Content)
 ANSI A117.1 (ADA)
 UL 1951

equip
 Foodservice
 Accessories

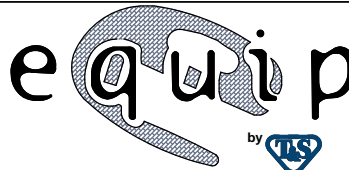

2 Saddleback Cove, P.O. Box 1088
 Travelers Rest, South Carolina 29690
 Phone: 800.891.4808 Fax: 800.868.0084
 equip.tsbrass.com